

1700, Setlakwe Street
 Thefford Mines (QC) G6G 8B2
 CANADA
 www.technometalpost.com

CONFIDENTIAL

THE INFORMATIONS CONTAINED
 IN THIS DRAWING IS THE SOLE
 PROPERTY OF TECHNO PIEUX INC.
 ANY REPRODUCTION IN PART OR
 AS A WHOLE WITHOUT THE WRITTEN
 PERMISSION OF TECHNO METAL POST INC.
 IS PROHIBITED

REVISIONS

DATE	DESCRIPTION	REV.

Client :

Client adress :

Project :

Drawing :
**Techno Metal Post
 Model P4
 (Above ground light
 structure)**

Approved by :

Date :
 2011-10-31

Scale :
 N/A

Drawing no:
 P4-G-R0-A-USA

Page number :
 SHEET 1 OF 1

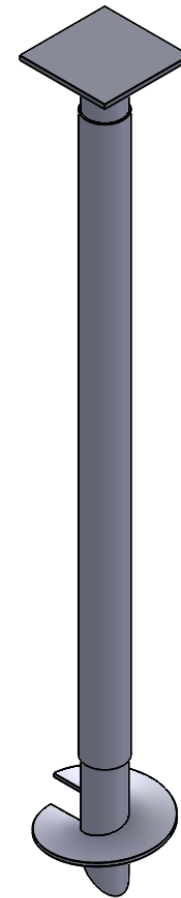

Supporting plate
 Standard : ASTM A36 - Steel
 (see note #6)

Steel shaft
 Model P4 : 4" x 0.226" [101.6mm x 5.7mm]
 Standard : ASTM A500 grade C - Circular steel section
 (see note #6)

Exclusive polyethylene sleeve
 (if required)

1/2" [12.7mm] thick factory-welded helix
 Standard : ASTM A36 - Steel
 (see note #6)

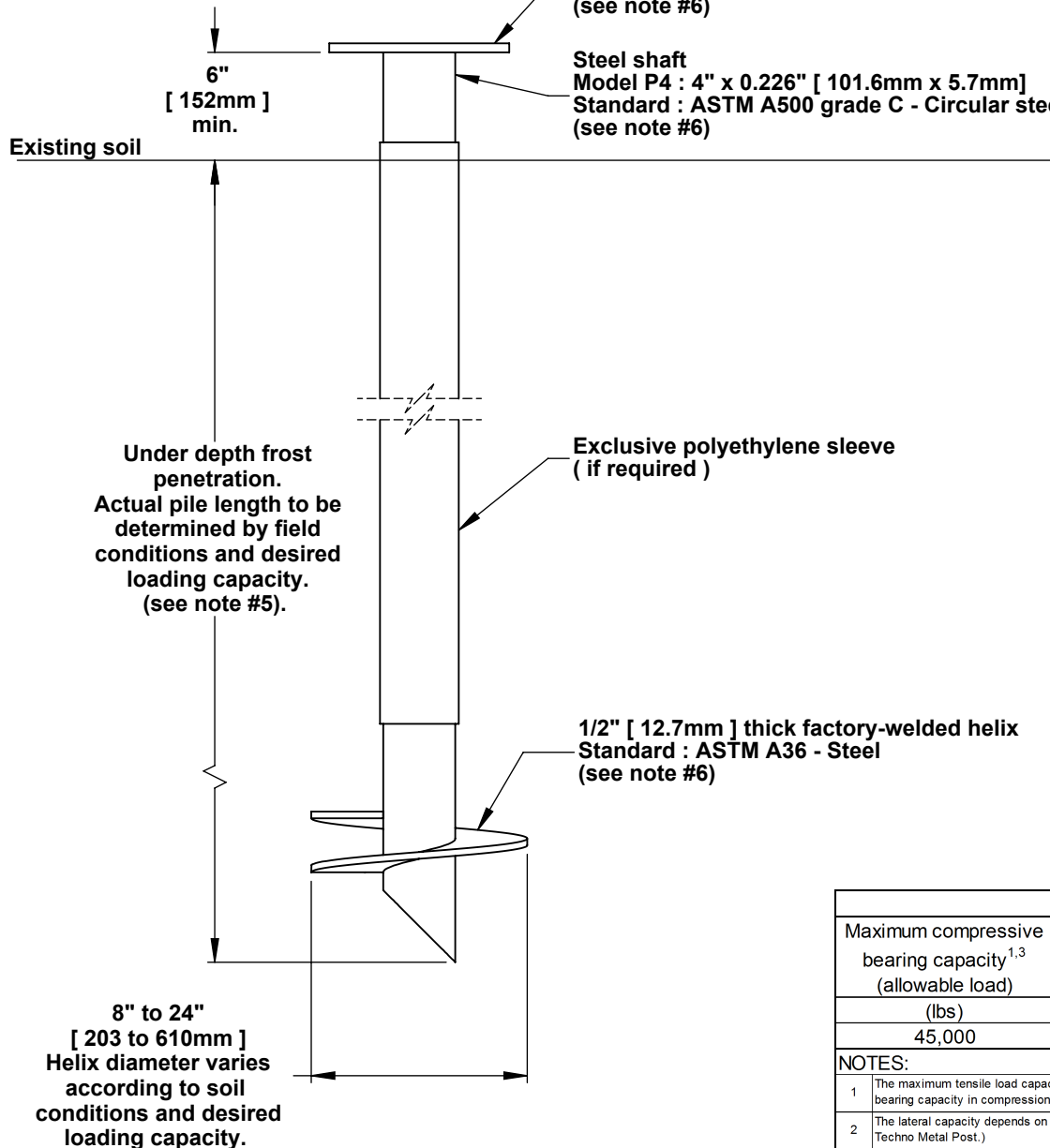

Load Capacity		
Maximum compressive bearing capacity ^{1,3} (allowable load)	Lateral bearing capacity ^{2,4} (allowable load)	Factored bending resistance (ultimate load)
(lbs)	(lbs)	(lbs.ft)
45,000	2,700	9,411

- NOTES:**
- The maximum tensile load capacity can be obtained, conservatively, by halving the values of the bearing capacity in compression shown in the selection table.
 - The lateral capacity depends on the density of soil (to validate consult technical department of Techno Metal Post.)
 - When the pile is laterally unsupported (soil very loose / soft, liquefiable soils, water and air), the structural strength of the pile must be approved by the technical department of Techno Metal Post.
 - The values of lateral capacity are average values and can be modified, more or less, depending on the characteristics of the existing soil.
 - If required, piles may be field welded with extensions to achieve greater loading capacities in poor soil conditions.
 - If required, the helical pile and the supporting plate can be galvanized in compliance with standard ASTM A123